

# **MADE LONDON at St Mary's Bryanston Square.**

**30<sup>th</sup> November – 1<sup>st</sup> December 2018.**

**MADE LONDON** at St Mary's is an exciting new project, which will take place at the end of November and start of December this year.

This show is a table-top, Christmas selling show reminiscent of village hall marketplaces and friendly table top sales, but in a stunning Georgian Church, and with some of the best makers in the country exhibiting - a truly unique experience for both makers and shoppers alike an enjoyable xmas shopping event.

There will be a cafe on the dais serving coffee and light refreshments.

## **VENUE**

St Mary's Bryanston Square is a spectacular, listed grade I listed Georgian Church with a stone portico and tower, designed by Robert Smirke in the 1820's. Located in Marylebone, located just 5 minutes' walk away from Edgware Road and Marylebone station. Marylebone itself takes its name from the St Mary's Church.



## **SPACE**

The show is a tabletop event - so may not be suitable for those needing walls to display their work. We will provide a 6ft trestle table, a black stretchy cover (or a 2m empty space if

you would like to bring your own display) and a plug socket. (We ask that you please use LED lights, to keep electric usage to a minimum). If you would like, we can also order you one or two IKEA standard lamps @ £25, which come fitted with a very bright LED bulb (for you to keep).

Although we will not have a shell scheme we want the show to look stylish so please keep display simple - keeping the focus on the work and be aware of how your display will look from the rear and side (and how it might affect your neighbours).

If you have your own display cabinet, then you are welcome to use that instead of the table. (max width 2m)

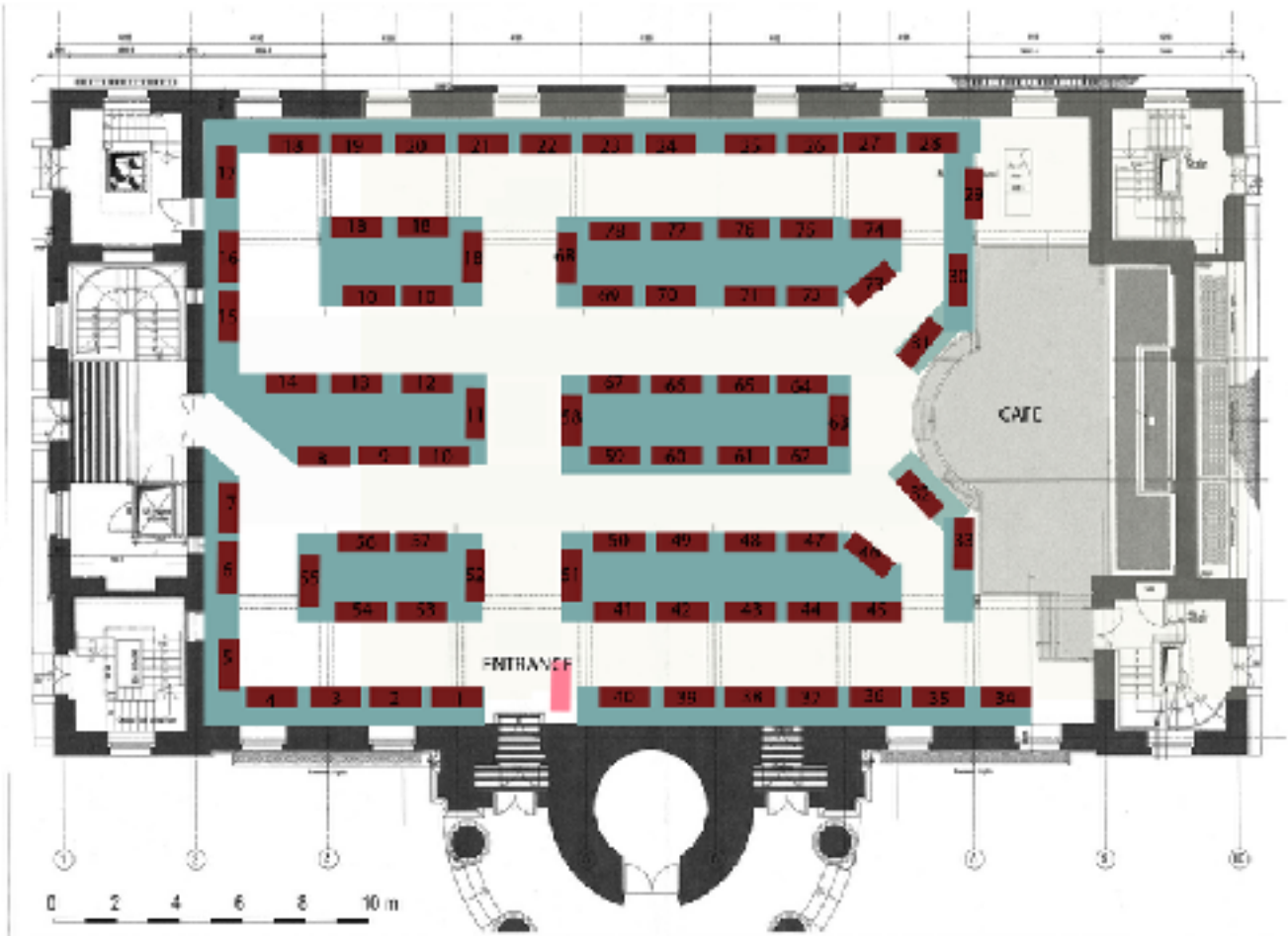

## APPLYING

Please apply using the online form - [www.madelondon-st-marys.co.uk](http://www.madelondon-st-marys.co.uk). Make sure that images are in the correct format. Images should be JPGs and no larger than 2MB in size.

Each image should have a MINIMUM OF 600 pixels on THE SHORTEST DIMENSION (width or height) and a maximum of 2000 pixels (recommended resolution is 1200 x 1200).

There is a charge for application of £8+VAT (this is to cover the costs associated with the the selection process and to ensure applicants are serious about taking part)

## **DEADLINE**

Applications are invited any time before 7<sup>st</sup> June. Selection will be made soon after.

## **PAYMENT**

Once placed we require a single payment of the full fee £395.00 + VAT (per space, should you require more than one!).

## **DATES & TIMES**

Friday	30 <sup>th</sup> November	-	08:00 – 11:00am - Unload and set-up. 11:00 – 18:00pm - Show open to the public.
Saturday	1 <sup>st</sup> December	-	11:00 – 18:00pm - Show open to the public, followed by pack down.

## **TICKETS**

There will be a charge for entry for the public into the show of £7 per person.

## **EXTRAS**

To buy Ikea lamp and bright LED bulb £25 each.

## **CONTACT INFORMATION**

### **We prefer email communication.**

**If after reading through this information pack you have any further questions, please email me on [info@tuttonandyoung.co.uk](mailto:info@tuttonandyoung.co.uk) if you are unable to use email, the MADE BRIGHTON phone number is 01903 608757. Please leave your message on the answer phone and we will get back to you.**

## **TERMS AND CONDITIONS**

**1 All work must be original and by the maker.**

**3 Makers cannot sublet their space or any part of it to another party without prior permission.**

**4 Makers cannot display the work or services of another party without prior permission.**

**5 Deposits are not refundable.**

**6 If the event is cancelled we will return your deposit and stand fee in full but cannot be held liable for any additional expenses incurred.**

**7 All stand fees must be paid in full by 1st November to confirm a space.**

**8 You are responsible for your own insurance of your work and public liability. We recommend joining a-n / AIR. AIR is a membership scheme.**

**9 Spaces are non-transferable.**

**10 All work displayed should ideally be for sale.**

**11 A few cards and postcards can be displayed and sold but must not dominate the space.**